

# HOME



HEAT SYSTEM

HEATER  
CONTROLLER  
-  
HORIZONTAL  
VERTICAL



+  
REMOTE  
CONTROLLER



H+h\_WIFI\_EN0920

## GUIDE & USER MANUAL

HEATER CONTROLLER H+h WiFi | REMOTE CONTROLLER H+R



## SAFETY:

1. **The heater should be installed by a qualified person.**
2. Bathroom radiators fitted with electric heaters should be fixed not less than 60 cm from a bath, shower or wash basin, and never above abath.
3. For the heater permanently connected (hard wire) there must be applied a cut-off device from the mains. Such a device must disconnect the heater from the supply mains in 2 poles, with contact separation of at least 3 mm.
4. This appliance can be used by children aged from 8 years and above and persons with reduced physical, sensory or mental capabilities or lack of experience and knowledge if they have been given supervision or instruction concerning use of the appliance in a safe way and understand the hazards involved
5. Children shall not play with the appliance. Cleaning and user maintenance shall not be made by children without supervision.
6. **The heater MUST BE DISCONNECTED before cleaning the casing. AVOID SOAKING THE CASING.**
7. One radiator valve must always be open when a heater is in use (liquid thermal expansion).

**CAUTION:** To avoid the risk of fire or electric shock the heater should be protected from water spray or flooding. This appliance is not intended for use by persons (including children) of limited physical, sensory or mental abilities, or persons inexperienced or not familiar with the appliance, unless supervised or instructed on the appliance use by persons responsible for their safety. Particular attention should be paid to children, to preclude playing with the appliance by them. Exclamation mark on triangular field signals:  **information important for the user.**

**CAUTION: electric shock hazard!**, lightning mark ended with arrow on triangular field 

**CAUTION:** in order to reduce electric shock hazard, do not remove the casing (nor its rear cover). There are no user-serviceable parts inside the appliance; the product must be returned to the manufacturer for repair via the distributor who sold the product.

## GUARANTEE TERMS:

Guarantee is granted by manufacturer for 24 months period starting from date of sale, but no longer than 36 months from date of the heater manufacture. Defects revealed within this period, resulting from a fault of manufacturer will be repaired free of charge or the item replaced with new, equivalent one. Term of complaints' investigation up to 14 (fourteen) days from date of submission to the manufacturer.

### Guarantee does not cover:

1. Using of product in a manner noncompliant with attached instructions.
2. Any visible damage to the heating element or controller due to improper use. Damaging of manufacturer's seals makes the guarantee null and void.

**In the event that Heatpol are unable to repair or replace this product we reserve the right to refund the purchase price as an alternative.**

## GUARANTEE CARD

Serial No.:

Date of sale:

Stamp of retail outlet, signature of seller



Mników 322, 32-084 Morawica, Poland  
Tel/fax: +48 12 656 44 91

MADE IN EU

**Caution:** The guarantee card should be legibly filled in retail outlet. Any corrections on the guarantee card will invalidate the guarantee. Guarantee card valid only with proof of purchase.

# USER MANUAL: Heating element + Heater controller (horizontal) H+h

## Kit content

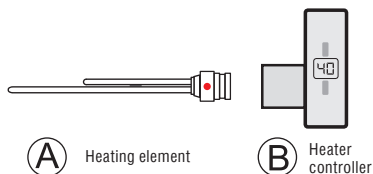

## Side connection

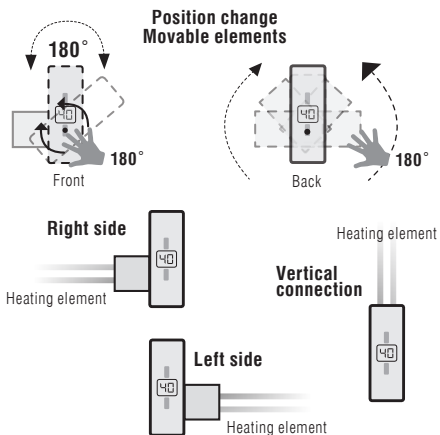

## Mounting in radiators

## CH system



## Electric radiators

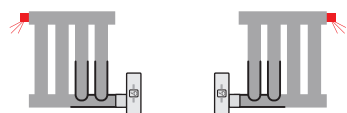

The electric heater must have a safety valve

## Installation details

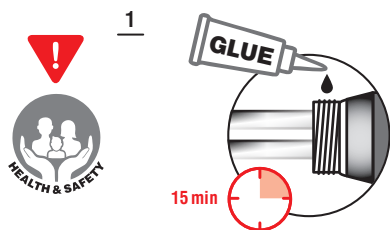

Before you apply the heating element, spread the Loctite glue (included in the set) on the middle of the thread circumference.

**GLUE**

## 2 The order of assembly of elements

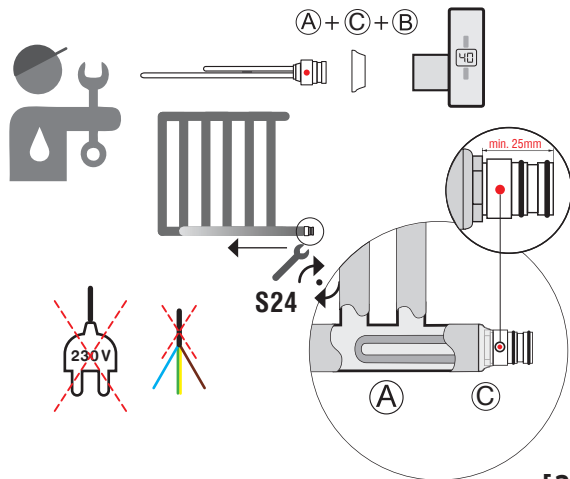

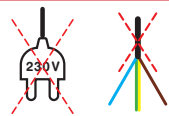

**CAUTION!** Do not disconnect heater controller when the system is powered.

The locking screw must be protected against accidental unscrewing eg. by applying a drop of lacquer or acrylic adhesive.

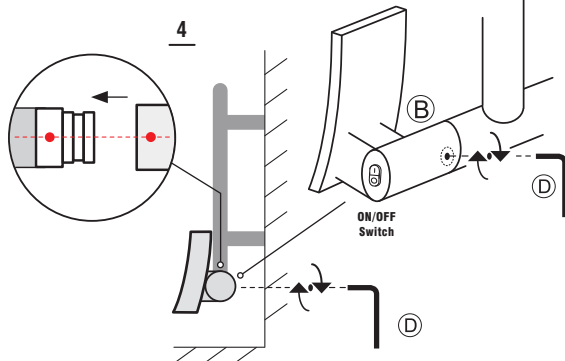
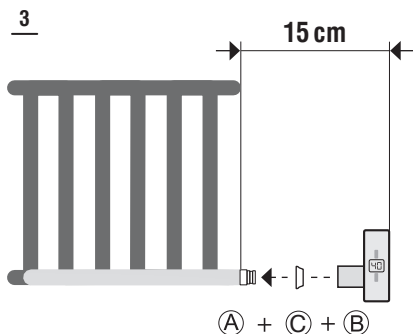

### Electric radiators

### CH system

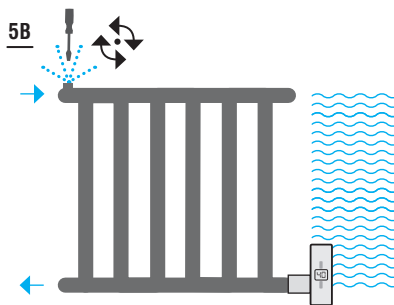
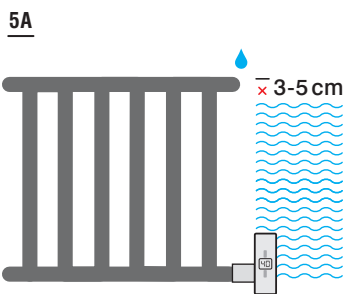

Before you apply the heating element, spread the Loctite glue (included in the set) on the middle of the thread circumference.

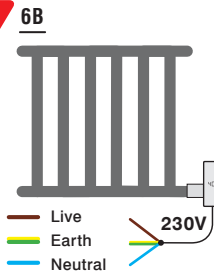
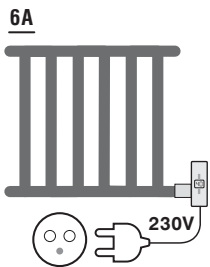

For the heater permanently connected (hard wire) there must be applied a cut-off device from the mains. Such a device must disconnect the heater from the supply mains in 2 poles, with contact separation of at least 3 mm

**7**

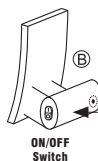

After electric connection, turn on the switch

# USER MANUAL: Heating element + Heater controller (horizontal/vertical) H+h

## Mounting in radiators

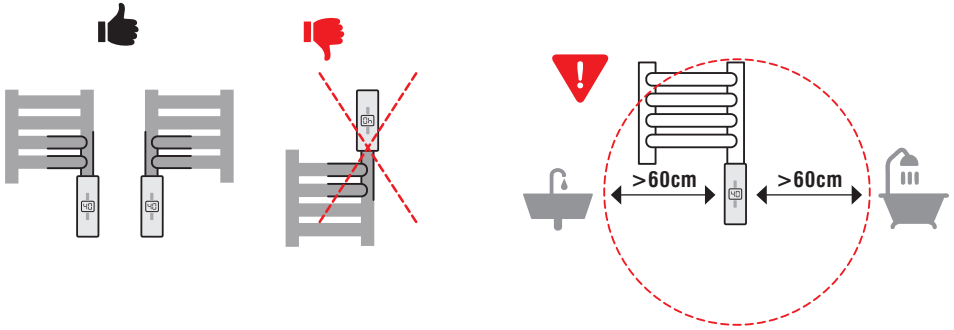

## Installation options: CH system

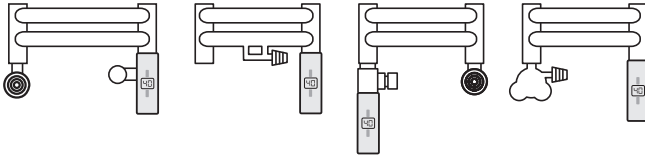

## Installation options: electric radiator

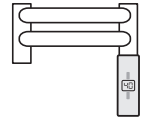

## Installation details

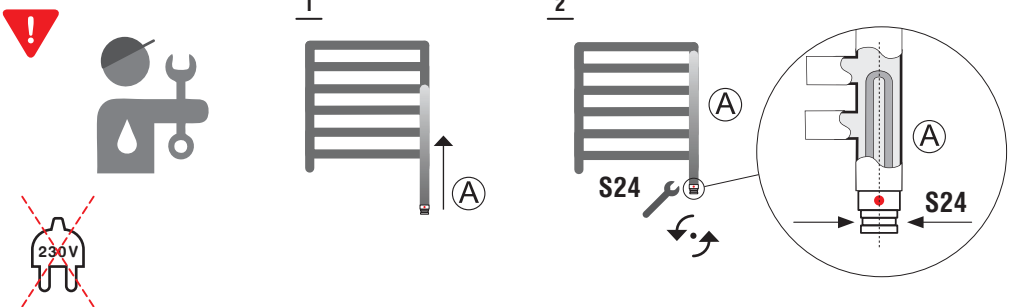

**CAUTION!** Do not disconnect heater controller when the system is powered.

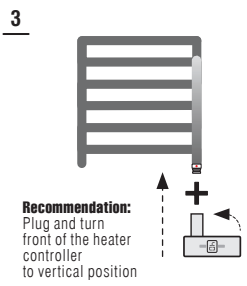

Electric radiators

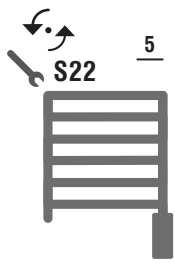
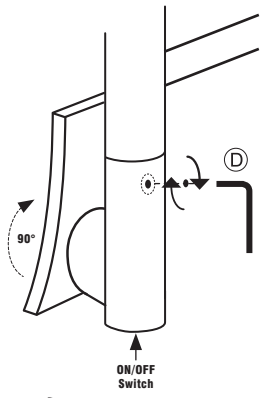
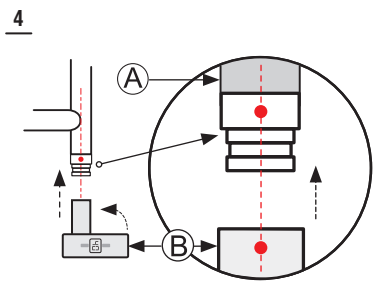

CH system

Finishing

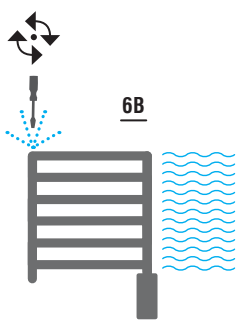
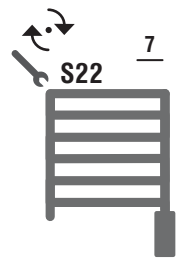
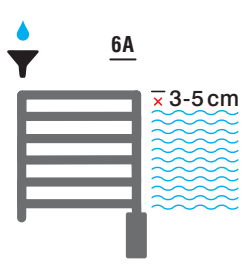

**9A Hard wire connection**

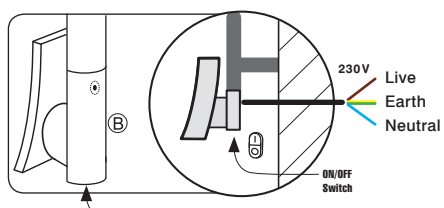

For the heater permanently connected (hard wire) there must be applied a cut-off device from the mains. Such a device must disconnect the heater from the supply mains in 2 poles, with contact separation of at least 3 mm

**10** After electric connection, **TURN ON** the switch (concern only hard wire connection)

**9B Connection with a coiled cable and a plug**

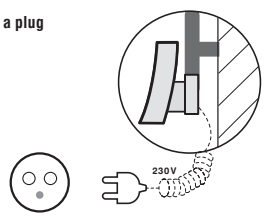

# USER MANUAL: How to use heater controller (optional remote controller)

VIDEO available at [www.homeplus-system.com](http://www.homeplus-system.com)

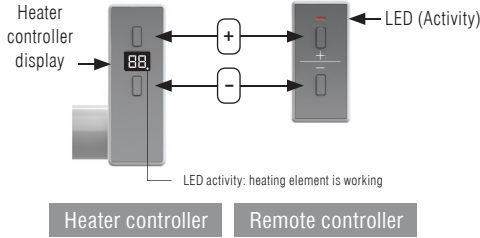

## Heater controller



Connect heater controller to the heater  
Use manufacturer recommendation  
Turn ON the controller



## Remote controller

Locate suitable place to mount the remote

Due to proper temperature reading do not place a remote controller (temperature sensor) over radiators, next to doors or in sunny places.

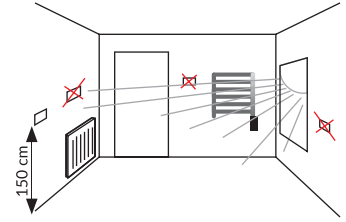

Push for pairing button using allen key to activate the controller

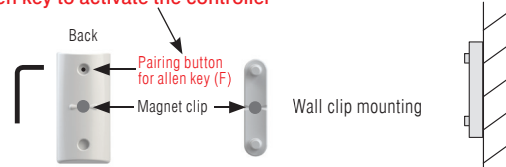

START: Heater controller and remote controller pairing

If you bought a remote controller together with H+heater you do not need to pair it!

Prepare remote controller + allen key for use ①

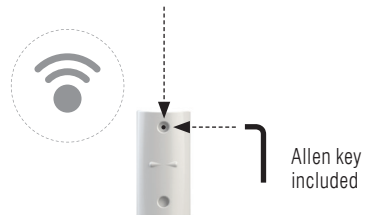
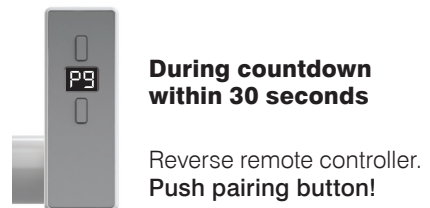
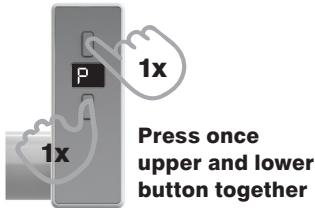

For H+h WiFi controller please download smartphone application from [www.supla.org](http://www.supla.org) and follow the instruction.



**Run the heater controller via remote controller**

Hold upper button for 3 seconds

**Switch off the controller via remote controller**

Hold lower button for 5 seconds

**40°C**  
Standard heating temperature

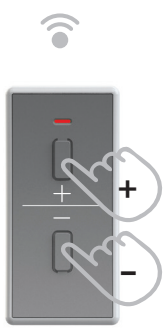

**10°C - 65°C\***  
Select temperature

TURBO mode activation

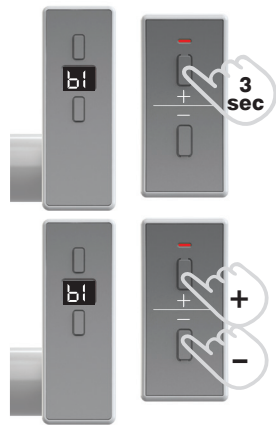

**TURBO mode activation - max heating temperature**  
Hold button for 3 seconds

**b1-b2-b3** Max heating temperature, **selection for 1/2/3 hours**

**b0** Off selection

Settings water or ambient temperature

Errors

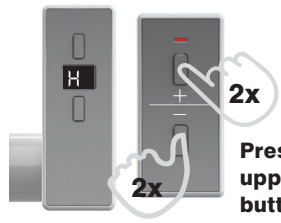

**Press twice upper and lower button together**

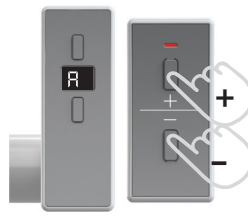

**Temperature selection.**  
**H** Water temperature 10-65°C\*  
**A** Ambient temperature 10-30°C

**The remote is a temperature sensor**



- E1** Lack of water (or wrong choice of heating element to the heater)
- E2** Damaged heating element (or no power circuit)
- E3** No communication to the remote controller if paired

[8] \* maximum temperature can be different according to the producer settings

**DO NOT DISCONNECT!**

controller from heating element, when connected to the power supply







**DOWNLOAD APPLICATION** [SUPLA.ORG](https://supla.org)



**Install the application on your devices.  
The app will easily guide you through  
individual installation steps.**





Mników 322, 32-084 Morawica, Polska  
Tel/fax: +48 12 656 44 91

[www.heatpol.pl](http://www.heatpol.pl)  
[www.homeplus-system.com](http://www.homeplus-system.com)

MADE IN EU